Bassett Convergence System

56806099

Copyright ©2007 Durham GeoSlope Indicator. All Rights Reserved.

This equipment should be installed, maintained, and operated by technically qualified personnel. Any errors or omissions in data, or the interpretation of data, are not the responsibility of Durham Geo Slope Indicator. The information herein is subject to change without notification.

This document contains information that is proprietary to Durham Geo Slope Indicator and is subject to return upon request. It is transmitted for the sole purpose of aiding the transaction of business between Durham Geo Slope Indicator and the recipient. All information, data, designs, and drawings contained herein are proprietary to and the property of Durham Geo Slope Indicator, and may not be reproduced or copied in any form, by photocopy or any other means, including disclosure to outside parties, directly or indirectly, without permission in writing from Durham Geo Slope Indicator.



12123 Harbour Reach Drive
Mukilteo, Washington, USA, 98275
Tel: 425-493-6200 Fax: 425-493-6250
E-mail: solutions@slope.com
Website: www.slopeindicator.com

Contents

Introduction	1
Installation	2
Components.....	2
Installation Tasks.....	2
Tools Required	3
Direction of View	4
Installing Mounting Brackets	5
Installing Pivot Pins.....	6
Installing Short Arms.....	7
Installing Long Arms	8
Installing Sensors.....	11
Installing Datalogger	12
Testing	13
Installation Record	14
Pin Coordinates	15

Introduction

- Applications** The Bassett convergence system provides automated surveys of a tunnel section. Typical applications include:
- Recording the behavior of tunnels and other underground openings to verify that actual performance conforms to predictions.
 - Monitoring deformation due to nearby construction activity or to slope movements and other natural disturbances.
 - Monitoring deformation in tunnels under construction to ensure safety and to control the rate of construction.

Operation The Bassett system uses tilt sensors to monitor the position of reference pins installed in a tunnel section. The sensors are linked to the pins via a system of low-profile arms. Spatial displacement of any pin changes the tilt of the arms connected to it and results in a changed tilt reading.

The system can be configured as a closed loop or left open-ended. With closed loops, a Bowditch correction can be applied to minimize the effects of errors. Open-ended systems are referenced to conventional surveys periodically unless one end is known to be stable.

At scheduled intervals, a data logger obtains a survey of the tunnel section by recording a reading from each tilt sensor. This requires five to ten seconds, depending on the number of sensors in the system.

A computer, running customized software retrieves the readings from the data logger, calculates displacement data, and generates a graphic display of the tunnel section.

Installation

Components

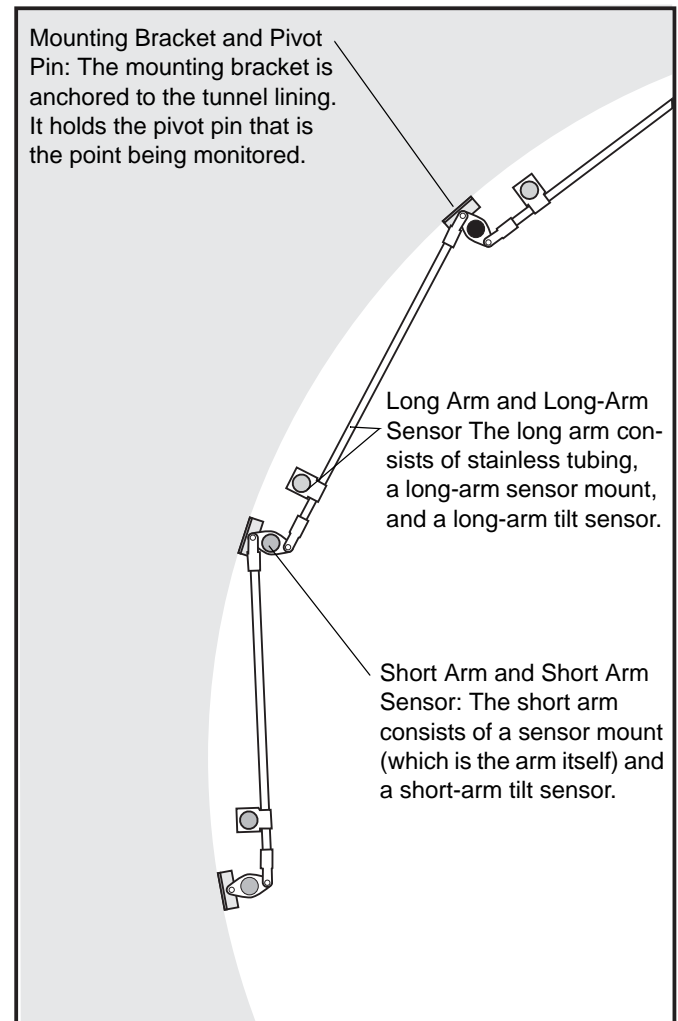

Installation Tasks

1. Establish a direction of view for the computer display.
2. Install mounting brackets in tunnel lining.
3. Install and align pivot pins in mounting brackets.
4. Install short arms.
5. Install long arms.
6. Install sensors.
7. Install data logging system.
8. Test, zero, and document sensors.
9. Install and test software.

Tools Required

- Drill motor
- Masonry bits
- Quick-grout or fast-cure resin
- Hacksaw or reciprocating saw with metal-cutting blades
- Tubing (conduit) bender
- Wire cutters & strippers
- Splicing / insulating materials
- Cable ties
- Misc. handtools (screwdrivers, pliers, wrenches, etc.)
- Pivoting laser device (optional)
- Readout device (datalogger w / laptop)

Direction of View

In the tunnel, you can view the Bassett System from either side, but on the computer screen, you can view the system from just one side. Therefore, it is necessary to establish a convention to relate the computer display to the real-world.

1. The computer screen will look similar to the drawing below. As you look through the Bassett section, what is the direction of your view? Specify a compass direction, such as "Looking North," "Looking East," etc.
2. "As-Installed" documentation must use the same direction of view. Starting from the lower left side, label the monitored points as A, B, C, D, etc, as shown below.
3. Two sensors will be installed for each monitored point, a short-arm sensor and a long-arm sensor. Starting from the lower left, label the sensors short #1 & long #1, short #2 & long #2, etc, as shown below.

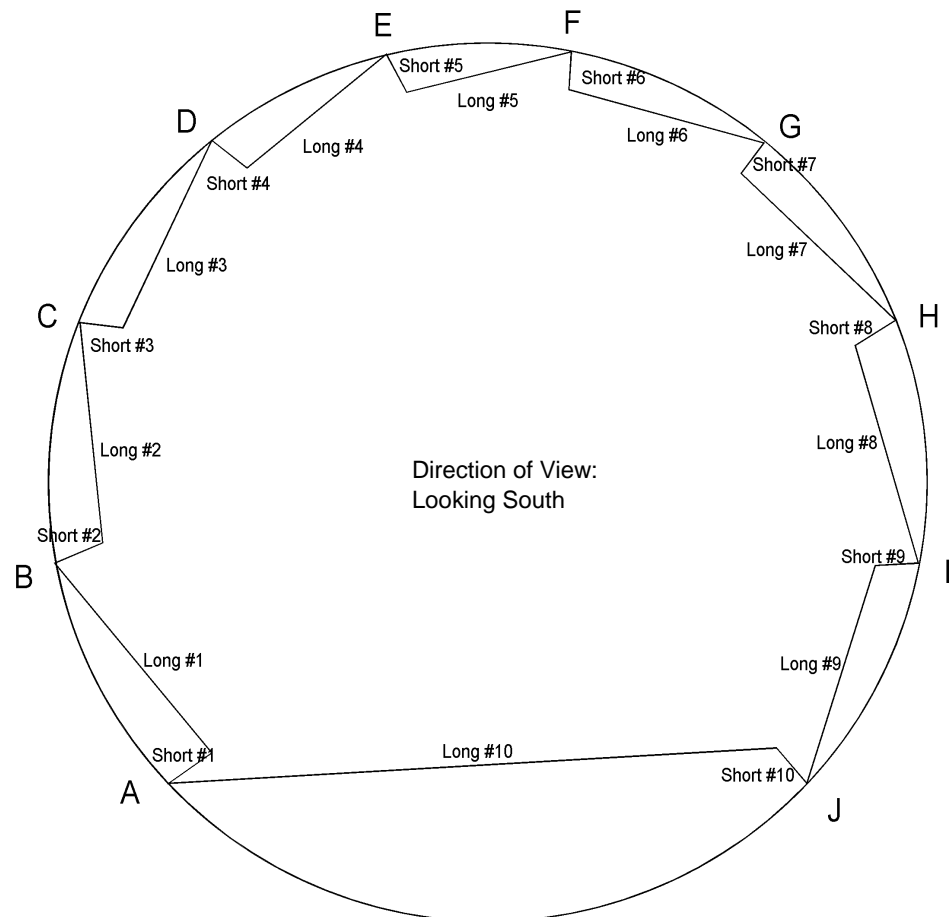

Install Mounting Brackets

To install the mounting brackets you will need to drill for M10 studs, either to be bolted to steel tunnel ribs or grouted into a concrete tunnel lining, so you'll need a drill slightly larger than 10mm for steel or fairly larger for concrete to accommodate the grout or resin you will use in that case. The studs are 200mm long, but part of that length accommodates the thickness of the bracket and a couple of nuts and washers for each stud that go on either side of the bracket, to level/position it and accommodate surface irregularities of the tunnel lining or supports.

If you are mounting to steel ribs, you may need some additional fasteners (nuts & washers) that are not supplied. The fasteners contained within are oriented toward grouting in only.

1. Mark locations for mounting brackets so that the plane of the Bassett section will be perpendicular to the tunnel lining.
2. Orient brackets so that anchor holes are on the side away from the viewer (see drawing below).
3. Install mounting brackets.
Grouted-in anchors are better than expanding anchors.

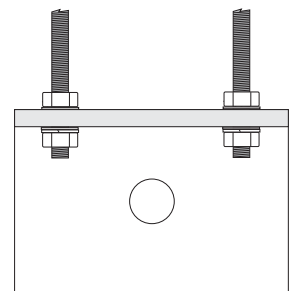

Install Pivot Pins

It is crucial to get the sensor pivots in the same geometric plane so that the pivots do not bind up, as that would lead to hysteresis in the system. An inexpensive laser on a pivot (as sold in home improvement stores) is very useful to establish the mounting bracket/pivot positions to achieve proper alignment.

1. Fit a pivot pin to each mounting bracket. Pivot pins should point towards the viewer (away from the viewing direction).
2. Adjust nuts so that the tip of each pin is in the same plane as the others. Then tighten nuts to keep pins in place.

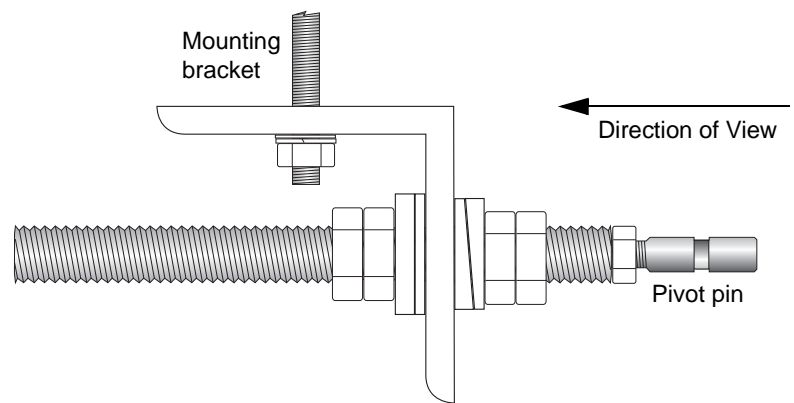

Install Short Arms

Short arms are packaged in plastic bags. Each bag contains a short-arm and two long-arm fittings. One fitting is attached to the short arm. One fitting is loose.

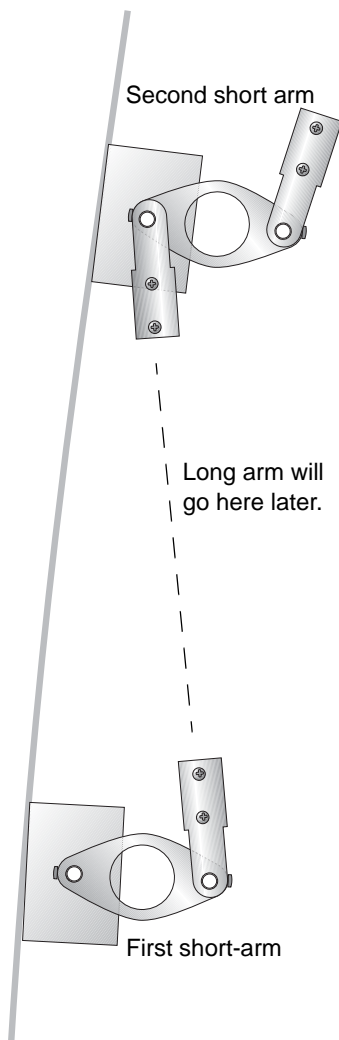
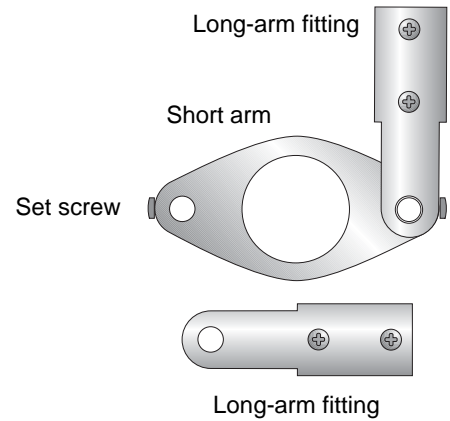

1. Start at the bottom pivot pin on the left side. Avoid working from both sides at once.
2. Fit the first short arm onto pivot pin. Tighten set screw. Save loose long-arm fitting for use on the last pivot pin.
3. Move to next pivot pin. Fit long-arm fitting onto short arm, then push both onto pivot pin. .
4. Continue mounting short arms until you reach the last pivot pin. It may be necessary to temporarily secure the long-arm fittings so that they will not hang into the kinematic envelope where they may be struck by vehicles.
5. At the last pivot pin, use only a long-arm fitting. Slide the collar into the fitting and push both onto the pivot pin. Then tighten the set screw.

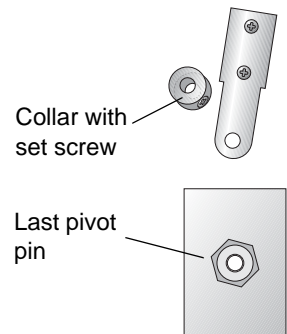

Install Long Arms

Long arms are made from stainless tubing, which you must measure, shape to fit, and cut to length. Start at the bottom left and work your way around to the last pivot pin on the right.

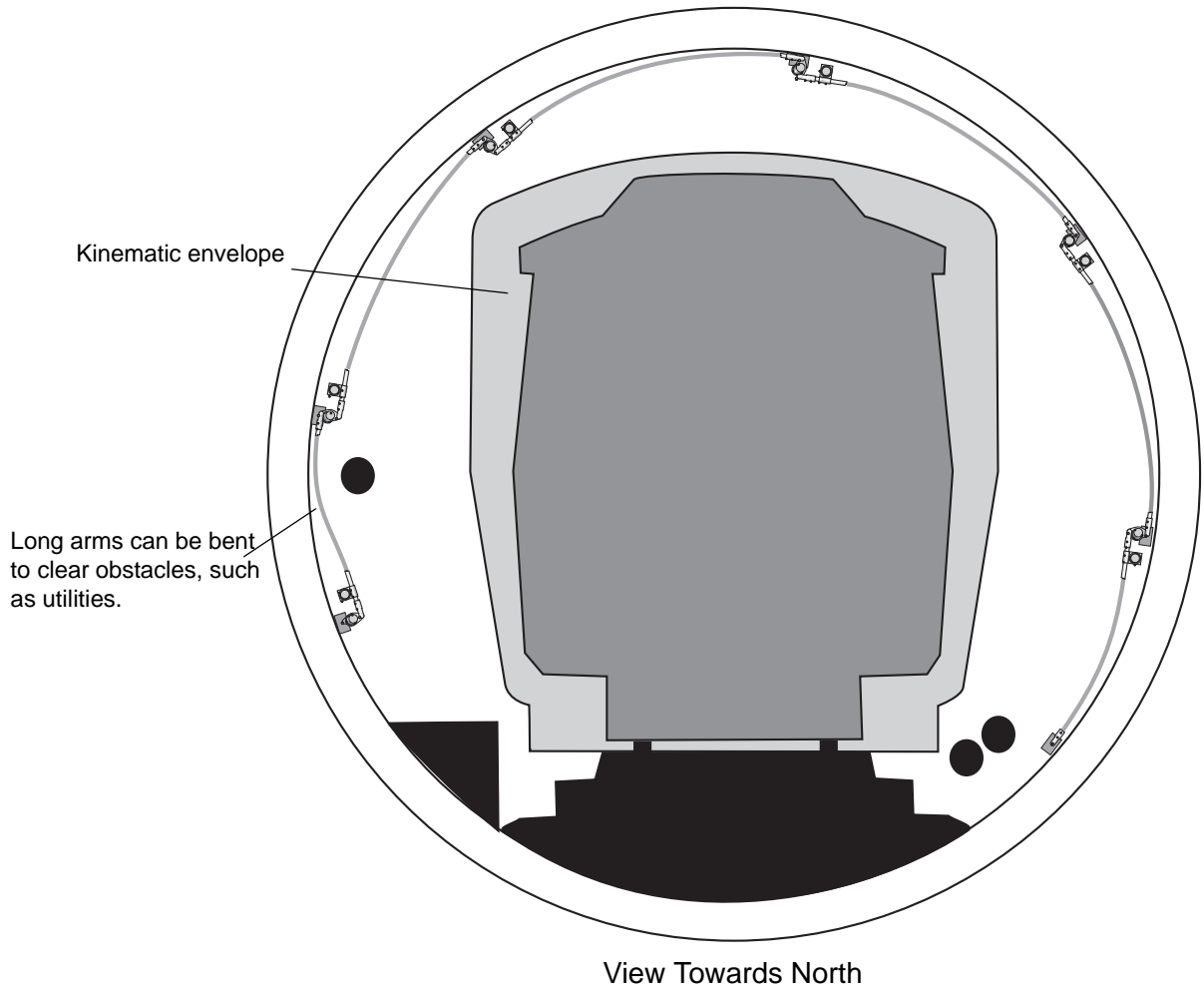

Measure tubing

1. Hold the first short arm perpendicular to the tunnel. Point its long-arm fitting at the next pivot pin.
2. At the same time, hold the next long arm fitting (the one mounted on the next pivot pin) and point it back at the first pivot pin.
3. Measure the distance between the two long-arm fittings. The tubing should fit all the way into the fittings. Allow extra length for the tubing if it is necessary to bend the tubing for clearance or to go around obstacles.

-
- | | |
|------------------------------------|--|
| Bend tubing | Bend tubing as required. <ol style="list-style-type: none">1. Check that obstacles are cleared by at least 20 mm.2. Be sure to keep 250 mm of straight tubing at either end. |
| Check length and cut tubing | <ol style="list-style-type: none">1. Hold tubing next to the long-arm fittings to check the fit.2. Also, check that the long-arm fitting is not locked against the short arm.3. Cut the tubing. This is now a long arm. |
| Install sensor mount | Slide the long-arm sensor mount onto the long arm. (The end that will be nearest the first short arm). |
| Install long arm | <ol style="list-style-type: none">1. Fit the long arm into both long arm fittings.<ul style="list-style-type: none">• It may be necessary to loosen screws in the long arm fittings.• It may be necessary to disconnect the long arm fitting from the short arm, slide it onto the long arm, and then reconnect the fitting to the short arm.2. Check the long arm one more time and then partially tighten the screws in the long-arm fittings.3. Repeat for remaining arms. |

**Test for free movement
then tighten screws**

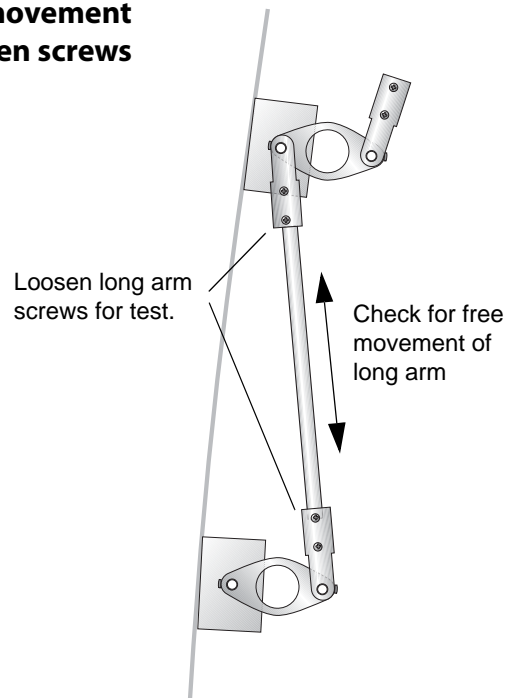

Follow the procedure below to check movement of each arm. Work from left to right.

1. Start at the first long arm on the left side. Loosen long-arm screws at both ends.
2. Check that long arm can freely slide in and out of long-arm fittings. If arm is binding, adjust position of pivot pin. (The tips of pivot pins must be in same plane. Also, the axis of the pivot pin must be parallel with other pivot pins.)
3. Tighten long arm screws. If you use a thread locking compound, be careful not to spill it on pivot points.

Install Sensors

The short-arm sensors look exactly like the long-arm sensors, so you must distinguish them by labels and serial numbers. Short arm sensors are mounted in the short arm. Long arm sensors are mounted on the long arm. The mounting procedure is the same for both.

1. Decide where your data logger will be placed.
2. Start installing sensors at the farthest point from the data logger and worked towards the data logger, dressing signal cables as you go.

Installation procedure

1. Insert sensor into sensor-mount as shown in drawing. If sensor is inserted from opposite side, make a note for the programmer.
2. Place retaining ring over end of sensor.
3. Slide retaining clip into groove in sensor body.
4. Insert screws but do not tighten until sensor is zeroed.

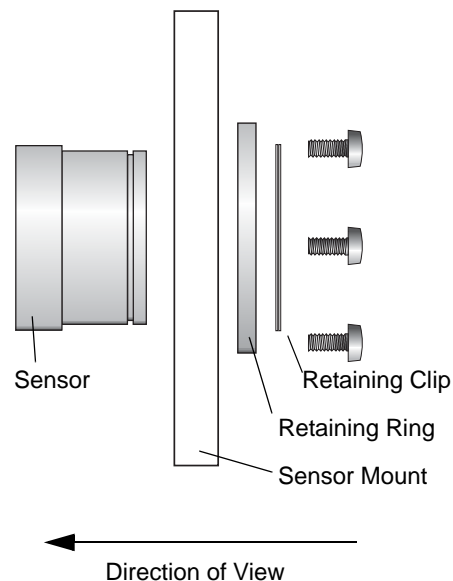

Dressing the cable

- Direct cable towards the data logger.
- Allow slack in the cable for strain relief. This will be needed when the arms move.
- If possible, fix cable to tunnel lining rather than to the arms.
- Avoid crossing pivot points. Make a loop in the cable to avoid moving parts.

Install Data Logger

- Install data logger as close as possible to the BSC system to avoid long runs of signal cable.
- Cut off excess signal cable. Do not loop excess signal cable under the logger. This can cause interference from adjacent high-voltage cables.
- Before connecting signal cable to the logger, cut off dirty ends and strip insulation back to expose clean conductors.
- Wire the data logger as directed by the wiring diagram supplied with the logger. A typical wiring diagram is shown below.

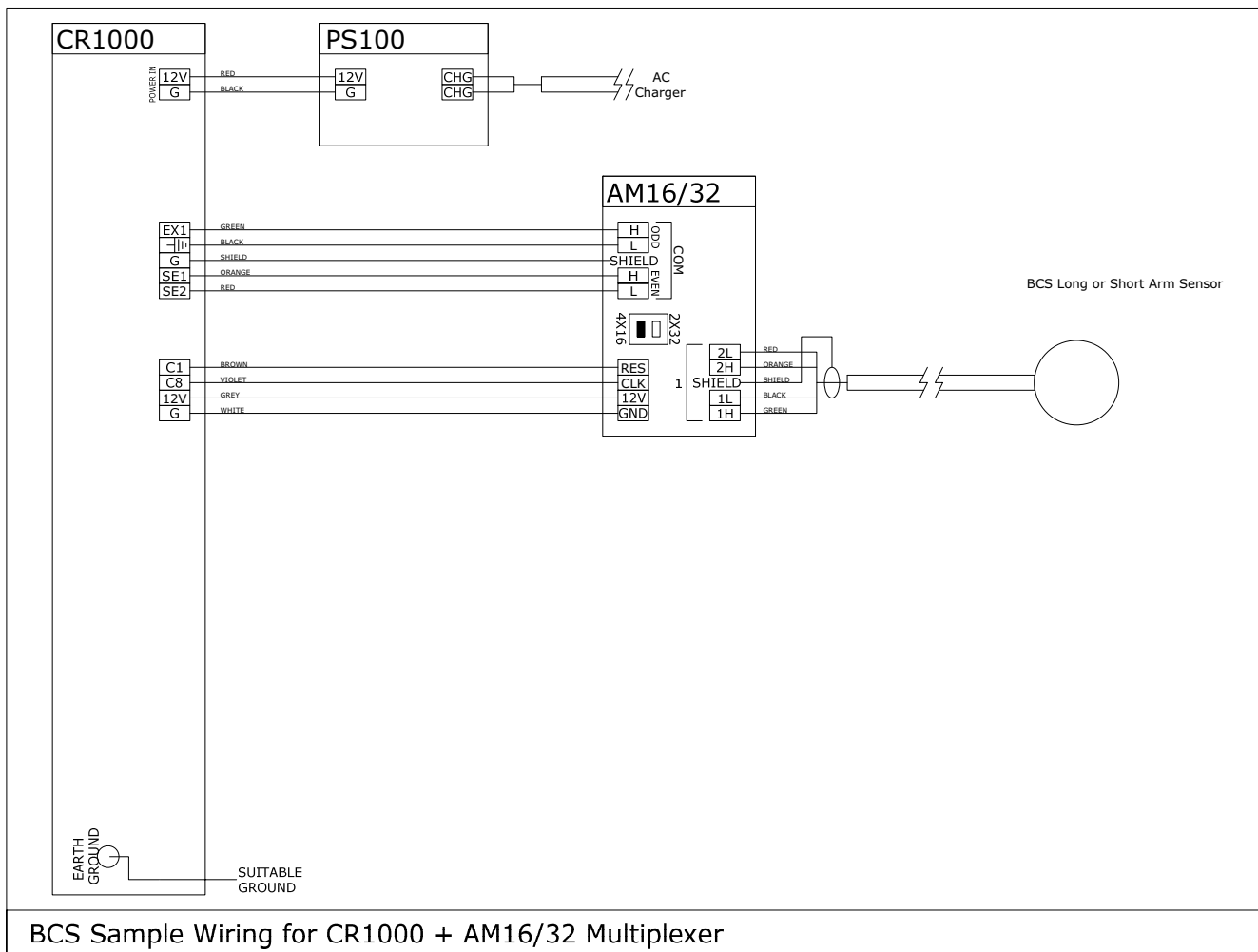

Test, Zero, and Document the Sensors

Use the installation record on the next page to document the sensors. Items to document are:

1. Direction of view
2. Sensor position
3. Sensor serial number
4. Sensor orientation (use raw readings)
5. Zero reading
6. Length of long arms

Testing sensors

1. Using LoggerNet, monitor the sensor input locations.
2. Note direction of view on installation record.
3. Note sensor position and its serial number on the installation record.
4. Check operation of sensor by rotating sensor and observing raw readings. Short arm sensor should have a range from 2 to 8 and read 5 at true horizontal. Long arm sensor should have range from 3.5 to 6.5 and read 5 at true horizontal.
5. Rotate sensor clockwise. Does reading increase or decrease? Note reading on installation record. This establishes the orientation of the sensor.

Zero sensors

1. Move the sensor until the output shows a null reading, which in raw units is a value of 5.0 ± 0.1 for both the long-arm and short-arm sensors.
2. Tighten the three screws to lock the sensor in position. Check that the null reading has not changed significantly.

Documentation

1. Record the straight line distance between the two ends of the long arms to the nearest mm. Use the installation record on the next page. All short arms are 100 mm long.
2. The Northing, Easting and elevation of points A, B, C, D, etc. should be established by optical survey. If it is not possible to survey in all of the points, calculate the coordinates using triangulation methods or measure the distances between pivot points. See Pin Coordinates form on page 12.

BCS INSTALLATION RECORD

Project Title:

Date of Installation:

Direction of View:

Project Engineer:

Sensor	Serial Number	Rotate sensor clockwise. Does reading increase (+) or decrease (-)? Mark the appropriate column.		Zero reading	Arm length: the straight line distance from pin to pin mm
		+	-		
Short arm #1					100
Short arm #2					100
Short arm #3					100
Short arm #4					100
Short arm #5					100
Short arm #6					100
Short arm #7					100
Short arm #8					100
Short arm #9					100
Short arm#10					100
Long arm #1					
Long arm #2					
Long arm #3					
Long arm #4					
Long arm #5					
Long arm #6					
Long arm #7					
Long arm #8					
Long arm #9					
Long arm #10					

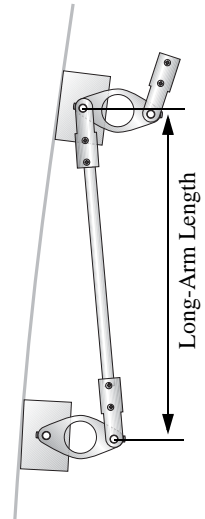

Pin Coordinates

Measurements Obtain the coordinates of all fixed pivot pins using an optical survey. In the example below, you would provide coordinates for pivot pins A through J.

Alternatively, you can measure distances from pin to pin, as shown in the drawing below. Measurements must be to the nearest mm. You must also provide the x and y distances between pins A and B, as shown in the drawing.

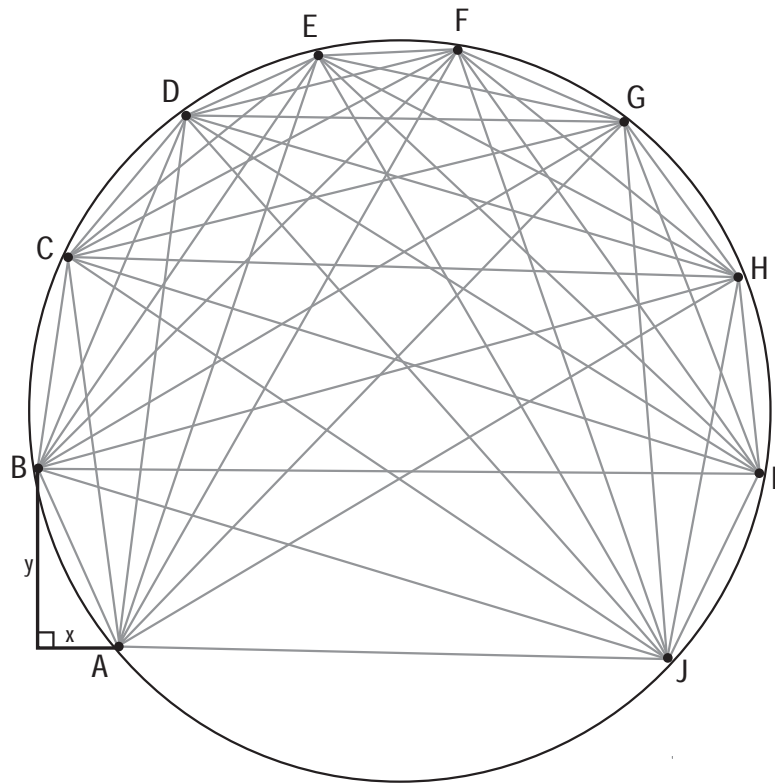

X										
Y										
AB										
AC	BC									
AD	BD	CD								
AE	BE	CE	DE							
AF	BF	CF	DF	EF						
AG	BG	CG	DG	EG	FG					
AH	BH	CH	DH	EH	FH	GH				
AI	BI	CI	DI	EI	FI	GI	HI			
AJ	BJ	CJ	DJ	EJ	FJ	GJ	HJ	IJ		